

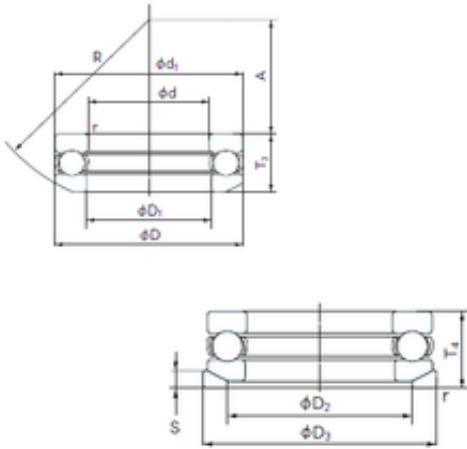

NACHI 53214U thrust ball bearings

Bearing No. 53214U



53214U Bearing 2D drawings and 3D CAD models

Size	70x105x32 mm
Bore Diameter	70 mm
Outer Diameter	105 mm
Width	32 mm
d	70 mm
D	105 mm
T	32 mm
d1	105 mm
r min.	1 mm
A	38 mm
D1	72 mm
D2	88 mm
D3	110 mm
R	80 mm
S	9 mm
Weight	0.980 Kg
Basic dynamic load rating (C)	76 kN
Basic static load rating (C0)	199 kN
(Grease) Lubrication Speed	1800 r/min